

Community Facilities

With our combination of skills in both planning & landscape architecture, Inukshuk has an ability to see the bigger picture, ensuring that function is never sacrificed for fluff.

Our approach to facility planning is analytical as well as aesthetic, with pleasing & comfortable design solutions backed up by solid research & innovation.

Copper Ridge Place

In a new approach to Northern long-term care facilities, Copper Ridge Place was built on a residential rather than medical management model. Inukshuk worked with residents, staff and experts to create therapeutic gardens that reflected the residents' desires, met the staff's programming requirements and maximized the therapeutic value of the outdoor spaces. Innovations such as the use of poured-in-place resilient rubber paving for increased fall safety were used for the first time in Canada's North.

Client: Government of Yukon

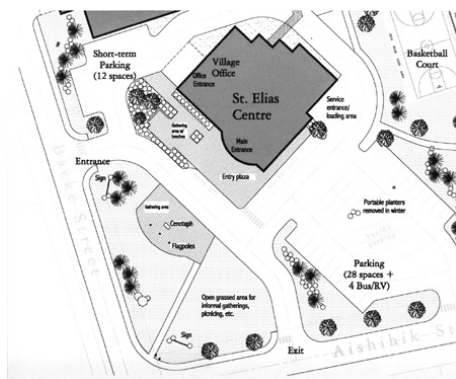

Client: Village of Haines Junction

Haines Junction Block 39 Landscape Plan

Block 39 is the "heart" of the village, containing the municipal offices, the new convention centre, a community centre and key recreational facilities such as the pool and arena. Inukshuk developed a landscape plan for the area that could be undertaken in phases, and that reconciled functional requirements such as the need for adequate parking with the desire to highlight the natural beauty of the surroundings.



Inukshuk Planning & Development LTD.

207 Elliott Street
Whitehorse, Yukon Y1A 2A1
Phone: (867) 667-4759

Fax: (867) 667-4020

E-mail: info@inukshukplanning.ca

www.inukshukplanning.ca

Grey Mountain Cemetery Expansion

The unconventional circular design for the expansion area recalls the ripples left when a pebble hits the water, evocative of the impressions we all make in the lives of others while we are here. A first for the Yukon, the expansion also includes a special area for the interment of children, recognizing the special grief and need to recognize and celebrate life that happens with the passing of a child.

Client: City of Whitehorse

